

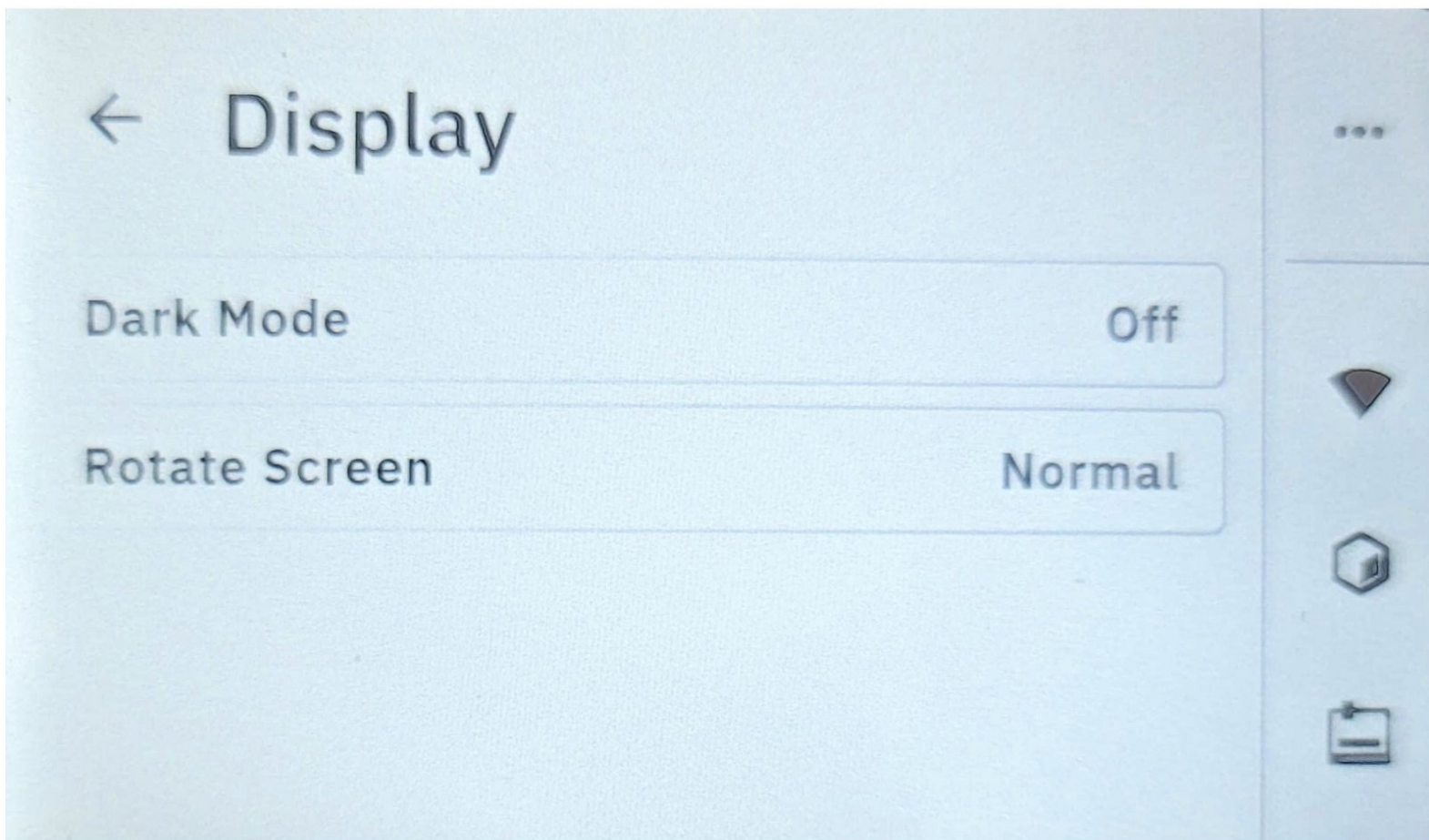

# Display Settings

How to change Dark Mode, Screen Saver, Rotate Screen, Brightness display settings

Written By: Mosaic Support



# INTRODUCTION

In this guide, you will learn how to:

- Change display settings on Palette 3, including how to enable dark mode, and rotate the display.

## Step 1 — Display

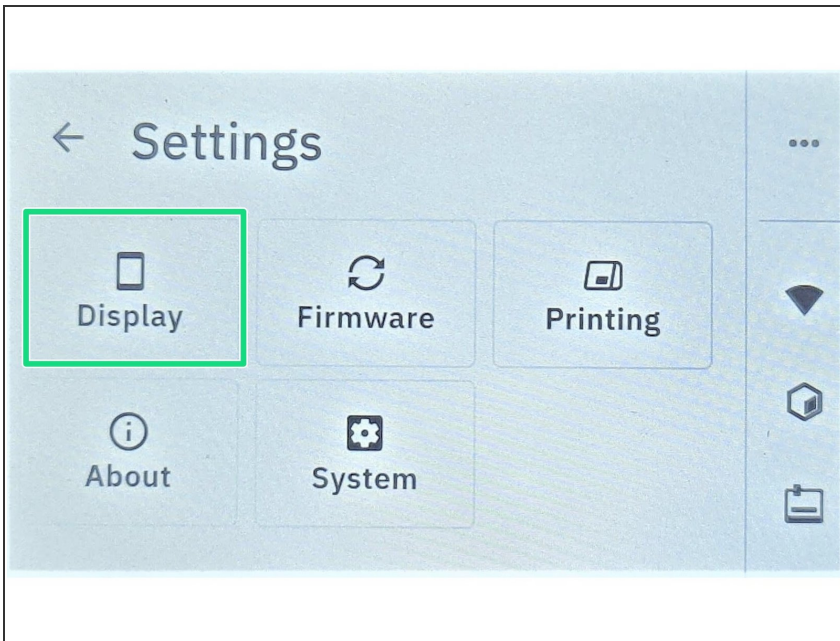

- Go to *Settings > Display* to see make changes to the following:
  - Dark Mode
  - Rotate Screen

## Step 2 — Dark Mode

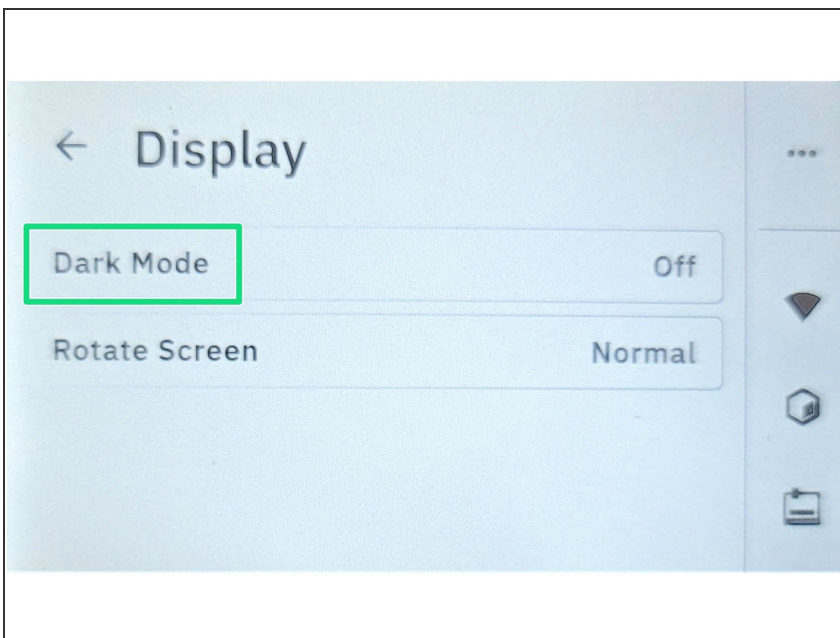

- This setting changes the color and lighting display between bright and dark.
- Tap *Dark Mode > On*.

## Step 3 — Rotate Screen

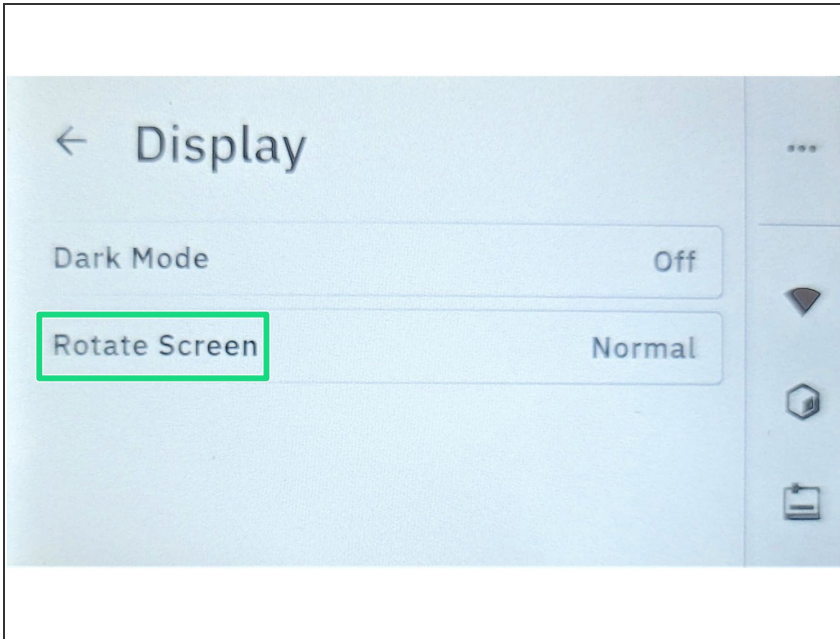

- This can be used for mounting Palette 3 upside down or other setups. To access this setting tap *Display > Rotate Screen*.
- To have the screen upright: *Rotate Screen > Normal*.
- To rotate the screen tap: *Rotate Screen > Flipped 180°*

If you have any additional questions, please send us a message at [support@mosaicmfg.com](mailto:support@mosaicmfg.com).